

**TOWN AND COUNTRY PLANNING ACT 1990
THE LAKE DISTRICT NATIONAL PARK AUTHORITY (LOW WOOD HOTEL,
WINDERMERE) TREE PRESERVATION (NO. 457) ORDER 2022**

THE LAKE DISTRICT NATIONAL PARK AUTHORITY, in exercise of the powers conferred on them by sections 198 of the Town and Country Planning Act 1990 make the following Order:-

Citation

1 This Order may be cited as The Lake District National Park Authority (Low Wood Hotel, Windermere) Tree Preservation (No. 457) Order 2022.

Interpretation

- 2(1) In this Order "the Authority" means the Lake District National Park Authority.
- 2(2) In this Order any reference to a numbered section is a reference to the section so numbered in the Town and Country Planning Act 1990 and any reference to a numbered regulation is a reference to the regulation so numbered in the Town and Country Planning (Tree Preservation) (England) Regulations 2012.

Effect

- 3(1) Subject to Article 4, this Order takes effect provisionally on the date on which it is made.
- 3(2) Without prejudice to subsections (7) of section 198 (Power to make Tree Preservation Orders) or subsection (1) of section 200 (Tree Preservation Orders: Forestry Commissioners), and subject to the exceptions in regulation 14, no person shall –
- (a) cut down, top, lop, uproot, wilfully damage, or wilfully destroy; or
 - (b) cause or permit the cutting down, topping, lopping, uprooting, wilful damage, or wilful destruction of,

any tree specified in the Schedule to this Order except with the written consent of the Authority in accordance with regulations 16 and 17, or of the Secretary of State in accordance with regulation 23, and, where such consent is given subject to conditions, in accordance with those conditions.

Application to trees to be planted pursuant to a condition

4 In relation to any tree identified in the first column of the Schedule by the letter "C", being a tree to be planted pursuant to a condition imposed under paragraph (a) of section 197 (planning permission to include appropriate provision for preservation and planting of trees), this Order takes effect as from the time when the tree is planted.

Dated the 23rd day of November 2022

Executed as a deed by affixing
the Common Seal of
LAKE DISTRICT NATIONAL PARK AUTHORITY
in the presence of:

Authorised Signatory

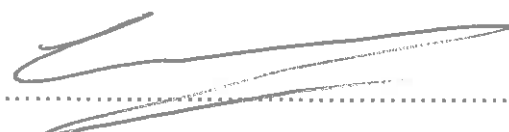

**SCHEDULE 1
SPECIFICATION OF TREES**

**Trees specified individually
(encircled in black on the map)**

<u>Reference on Map</u>	<u>Description</u>	<u>Situation</u>
T1	Oak tree	Situated on the southern boundary, adjacent to Holbeck Ghyll woodland, as shown on the plan
T2	Oak tree	Situated near the southern boundary, adjacent to Holbeck Ghyll woodland, as shown on the plan
T3	Yew tree	Situated on the bank to the rear of the hotel, as shown on the plan
T4	Beech tree	Situated near the workshop and storage area, as shown on the plan
T5	Oak tree	Situated on the western boundary and adjacent to the entrance to the hotel, as shown on the plan
T6	Pine tree	Situated on the southern side of the spa area, as shown on the plan
T7	Oak tree	Situated on the southern side of the spa area, as shown on the plan
T8	Oak tree	Situated on the southern side of the spa area, as shown on the plan
T9	Alder tree	Situated on the lake shore, as shown on the plan

**Trees specified by reference to an area
(within a dotted black line on the map)**

<u>Reference on Map</u>	<u>Description</u>	<u>Situation</u>
	N/A	

**Groups of trees
(within a broken black line on the map)**

<u>Reference on Map</u>	<u>Description (including no of trees in the group)</u>	<u>Situation</u>
G1	1 x Ash tree	Situated on the southern boundary,

	1 x Oak tree	adjacent to Holbeck Ghyll woodland, as shown on the plan
G2	3 x Willow trees 2 x Birch trees	Situated on the southern side of the of the main car park, as shown on the plan
G3	1 x Oak tree 1 x Alder tree	Situated on the lake shore, as shown on the plan

Woodlands

(within a continuous black line on the map)

<u>Reference on Map</u>	<u>Description</u>	<u>Situation</u>
W1	Mixed species woodland	Situated on the southern boundary, adjacent to Holbeck Ghyll woodland, as shown on the plan
W2	Mixed species woodland	Situated near the southern boundary, adjacent to Holbeck Ghyll woodland, as shown on the plan
W3	Mixed species woodland	Situated on the eastern side of the hotel, as shown on the plan
W4	Mixed species woodland	Situated near the southern boundary, adjacent to Holbeck Ghyll woodland, as shown on the plan
W5	Mixed species woodland	Situated near the southern boundary, adjacent to Holbeck Ghyll woodland, as shown on the plan
W6	Mixed species woodland	Situated near the southern boundary, adjacent to Holbeck Ghyll woodland, as shown on the plan
W7	Mixed species woodland	Situated near the southern boundary, adjacent to Holbeck Ghyll woodland, as shown on the Plan
W8	Mixed species woodland	Situated near the south-eastern boundary, adjacent to Holbeck Ghyll woodland, as shown on the plan

W9	Mixed species woodland	Situated on the eastern side of the hotel, as shown on the plan
W10	Mixed species woodland	Situated on the northern side of the main car parking area, as shown on the plan
W11	Mixed species woodland	Situated on the southern side of the main hotel, as shown on the plan
W12	Mixed species woodland	Situated on the eastern side of the hotel, as shown on the plan

This Order was confirmed by the Lake District National Park Authority without modification as an unopposed Order on the 9th day of May 2023

Signed on behalf of the Lake District National Park Authority

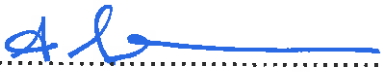

.....

Authorised Signatory

THE LAKE DISTRICT NATIONAL PARK AUTHORITY
(Low Wood Hotel, Windermere)
TREE PRESERVATION (NO. 457) ORDER, 2022

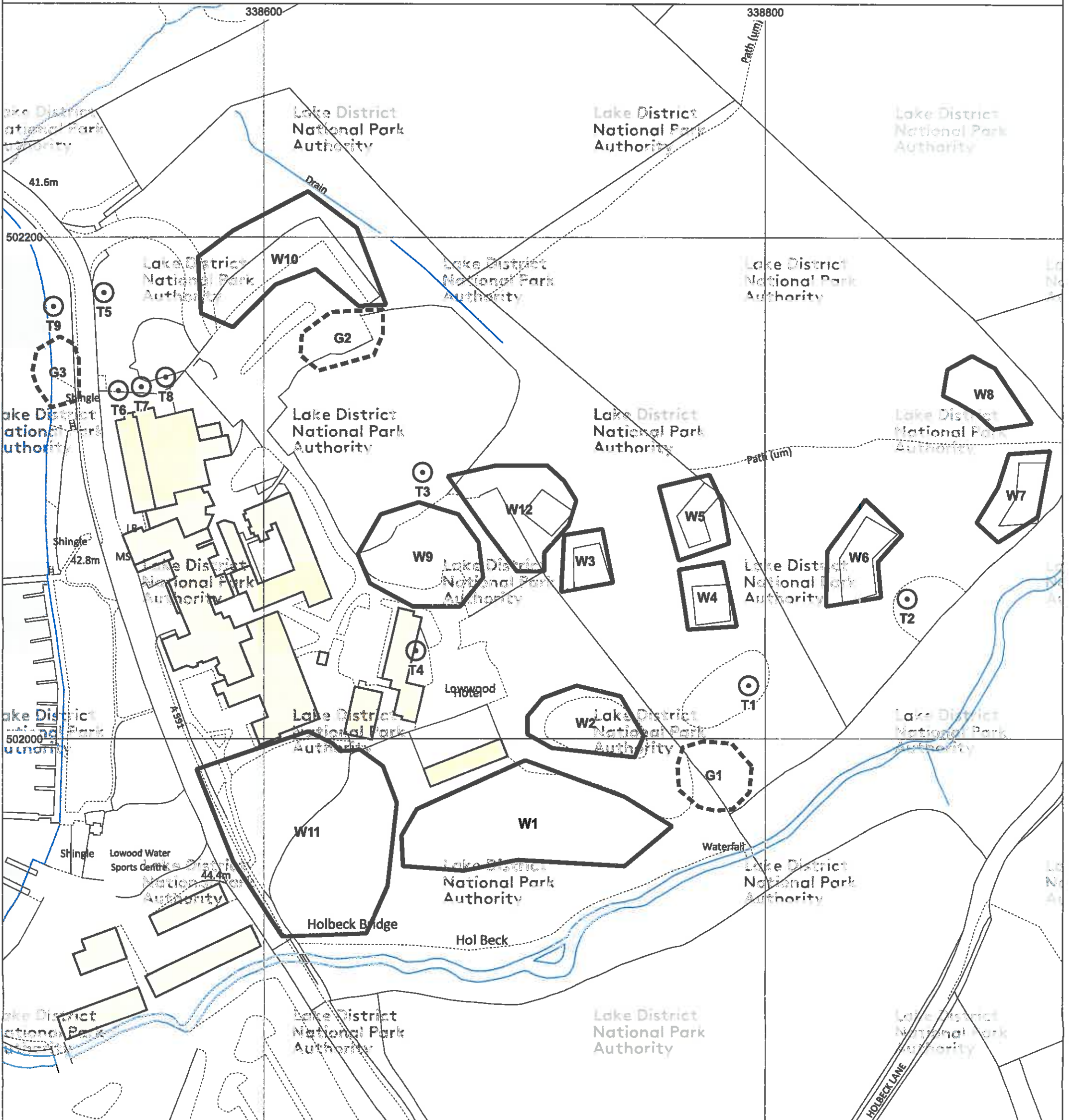

Tree Preservation Orders © Lake District National Park Authority 2022
 © Crown copyright and database right 2022 Ordnance Survey 100021698
 You are not permitted to copy, sub-licence, distribute or sell any of this data to third parties in any form

Given under the Common seal of the
 Lake District National Park Authority
 This 23rd day of November
 Two thousand and twenty two

Authorised Signatory

- Tree
- Group
- Woodland

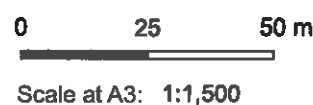

DATED: 23 November 2022

**LAKE DISTRICT NATIONAL PARK
AUTHORITY**

TOWN AND COUNTRY PLANNING ACT 1990

**THE LAKE DISTRICT NATIONAL PARK
AUTHORITY (LOW WOOD HOTEL,
WINDERMERE) TREE PRESERVATION
(NO. 457) ORDER 2022**

Julie Wood
Solicitor
Wayfaring House
Murley Moss
Oxenholme Road
Kendal LA9 7RL
Tel No: 01539 792665
Email: Julie.Wood@lakedistrict.gov.uk