

**TOWN AND COUNTRY PLANNING ACT 1990**  
**THE LAKE DISTRICT NATIONAL PARK AUTHORITY (LAND ASSOCIATED WITH HOLLY**  
**HOUSE, POOLEY BRIDGE) TREE PRESERVATION (NO. 452) ORDER 2022**

THE LAKE DISTRICT NATIONAL PARK AUTHORITY, in exercise of the powers conferred on them by sections 198 of the Town and Country Planning Act 1990 make the following Order:-

**Citation**

1 This Order may be cited as The Lake District National Park Authority (Land associated with Holly House, Pooley Bridge) Tree Preservation (No. 452) Order 2022.

**Interpretation**

- 2(1) In this Order "the Authority" means the Lake District National Park Authority.
- 2(2) In this Order any reference to a numbered section is a reference to the section so numbered in the Town and Country Planning Act 1990 and any reference to a numbered regulation is a reference to the regulation so numbered in the Town and Country Planning (Tree Preservation) (England) Regulations 2012.

**Effect**

- 3(1) Subject to Article 4, this Order takes effect provisionally on the date on which it is made.
- 3(2) Without prejudice to subsections (7) of section 198 (Power to make Tree Preservation Orders) or subsection (1) of section 200 (Tree Preservation Orders: Forestry Commissioners), and subject to the exceptions in regulation 14, no person shall –
- (a) cut down, top, lop, uproot, wilfully damage, or wilfully destroy; or
  - (b) cause or permit the cutting down, topping, lopping, uprooting, wilful damage, or wilful destruction of,

any tree specified in the Schedule to this Order except with the written consent of the Authority in accordance with regulations 16 and 17, or of the Secretary of State in accordance with regulation 23, and, where such consent is given subject to conditions, in accordance with those conditions.

**Application to trees to be planted pursuant to a condition**

4 In relation to any tree identified in the first column of the Schedule by the letter "C", being a tree to be planted pursuant to a condition imposed under paragraph (a) of section 197 (planning permission to include appropriate provision for preservation and planting of trees), this Order takes effect as from the time when the tree is planted.

Dated the 1<sup>st</sup> day of September 2022

Executed as a deed by affixing  
the Common Seal of  
LAKE DISTRICT NATIONAL PARK AUTHORITY  
in the presence of:

Authorised Signatory . . . . .



**SCHEDULE 1  
SPECIFICATION OF TREES**

**Trees specified individually  
(encircled in black on the map)**

<u>Reference on Map</u>	<u>Description</u>	<u>Situation</u>
T1	Ash tree	Situated on the eastern side of the footpath, as shown on the plan

**Trees specified by reference to an area  
(within a dotted black line on the map)**

<u>Reference on Map</u>	<u>Description</u>	<u>Situation</u>
	N/A	

**Groups of trees  
(within a broken black line on the map)**

<u>Reference on Map</u>	<u>Description (including no of trees in the group)</u>	<u>Situation</u>
G1	2 x Sycamore trees 1 x Lime tree	Situated on the northern boundary of the field associated with Holly House, as shown on the plan

**Woodlands  
(within a continuous black line on the map)**

<u>Reference on Map</u>	<u>Description</u>	<u>Situation</u>
W1	Mixed species woodland	Situated adjacent to the eastern boundary of the field associated with Holly House, as shown on the plan

This Order was confirmed by the Lake District National Park Authority without modification as an unopposed Order on the 22<sup>nd</sup> day of February 2023

Signed on behalf of the Lake District National Park Authority



Authorised Signatory

# THE LAKE DISTRICT NATIONAL PARK AUTHORITY (Land Associated with Holly House, Pooley Bridge) TREE PRESERVATION (No. 452) ORDER, 2022

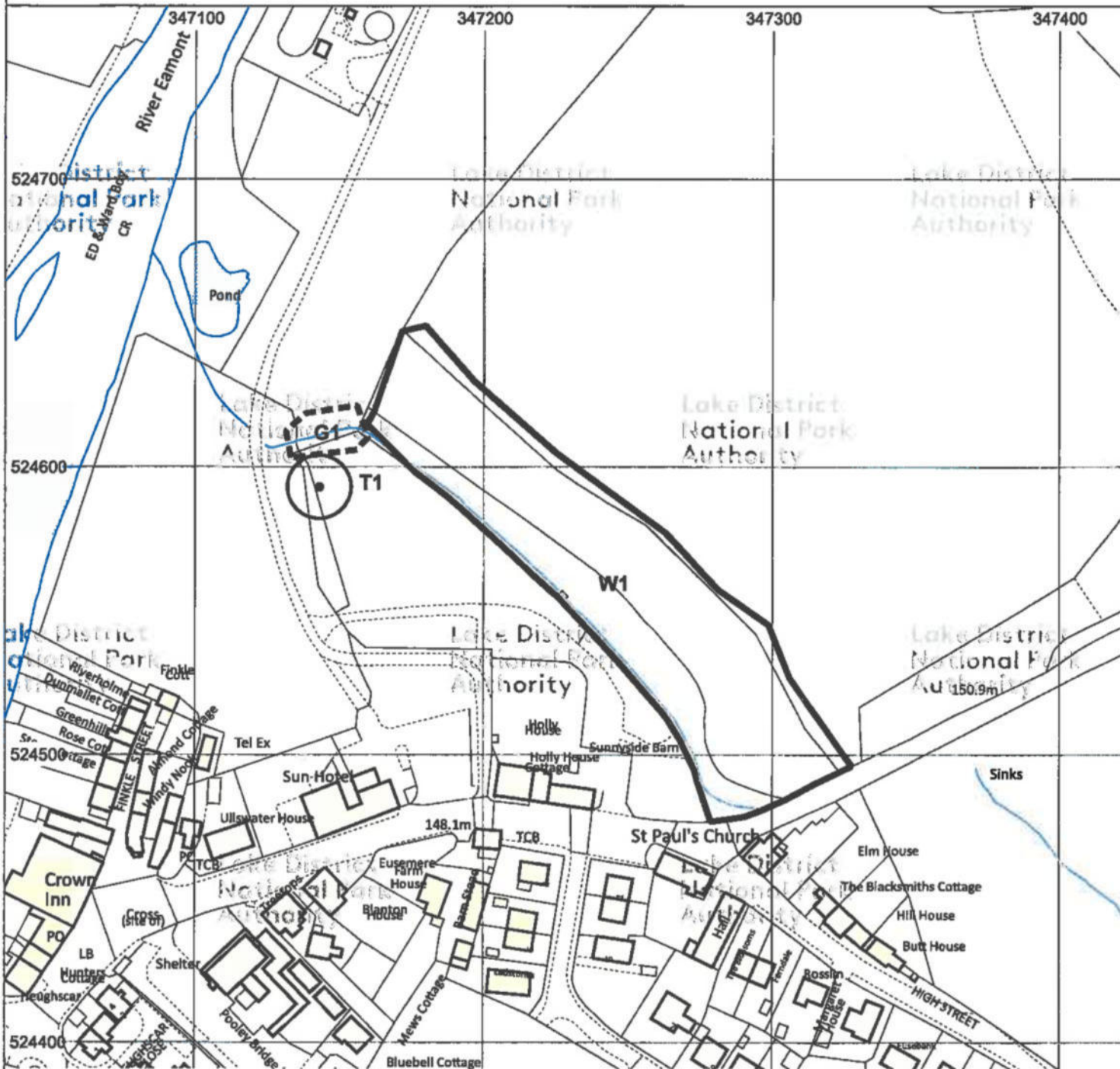

Tree Preservation Orders © Lake District National Park Authority 2022

© Crown copyright and database right 2022 Ordnance Survey 100021698

You are not permitted to copy, sub-licence, distribute or sell any of this data to third parties in any form

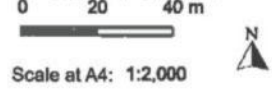

Given under the Common seal of the  
Lake District National Park Authority

This 10<sup>th</sup> day of September

Two thousand and twenty two



..... Authorised Signatory



**DATED: 1 September 2022**

**LAKE DISTRICT NATIONAL PARK  
AUTHORITY**

**TOWN AND COUNTRY PLANNING ACT 1990**

**THE LAKE DISTRICT NATIONAL PARK  
AUTHORITY (LAND ASSOCIATED WITH  
HOLLY HOUSE, POOLEY BRIDGE) TREE  
PRESERVATION (NO. 452) ORDER 2022**

Julie Wood  
Solicitor  
Wayfaring House  
Murley Moss  
Oxenholme Road  
Kendal LA9 7RL  
Tel No: 01539 792665  
Email: [Julie.Wood@lakedistrict.gov.uk](mailto:Julie.Wood@lakedistrict.gov.uk)